

# Silver Galapagos – DECK PLAN

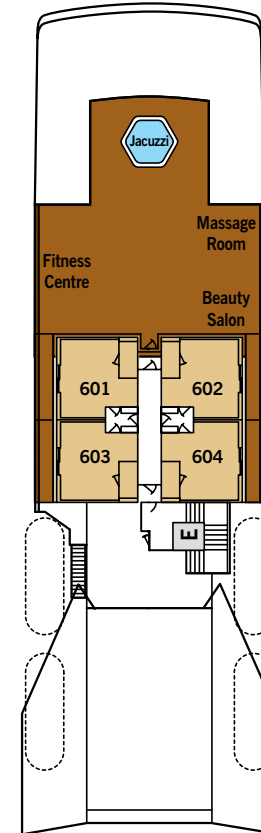
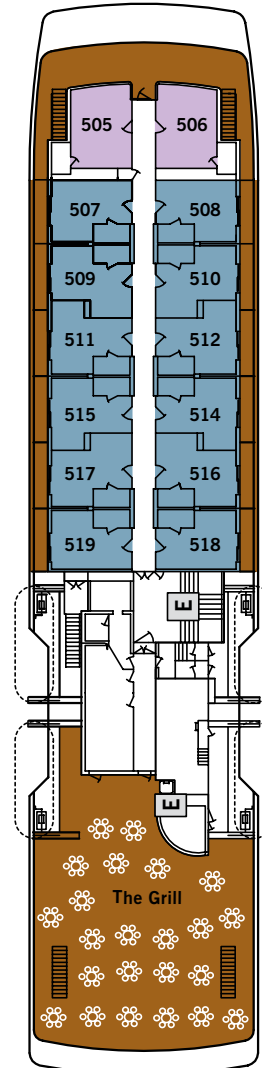
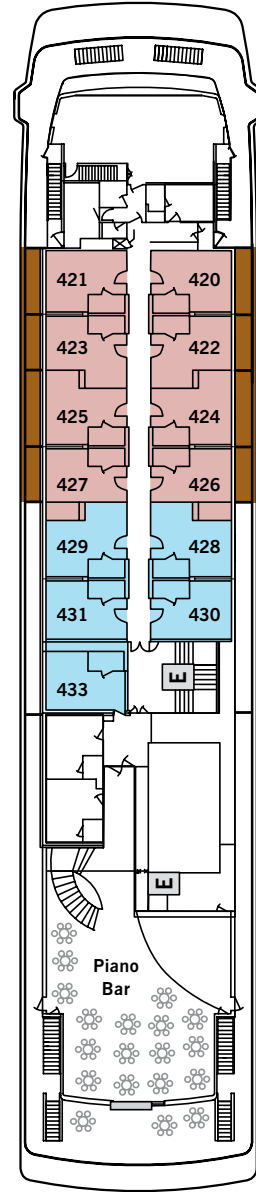
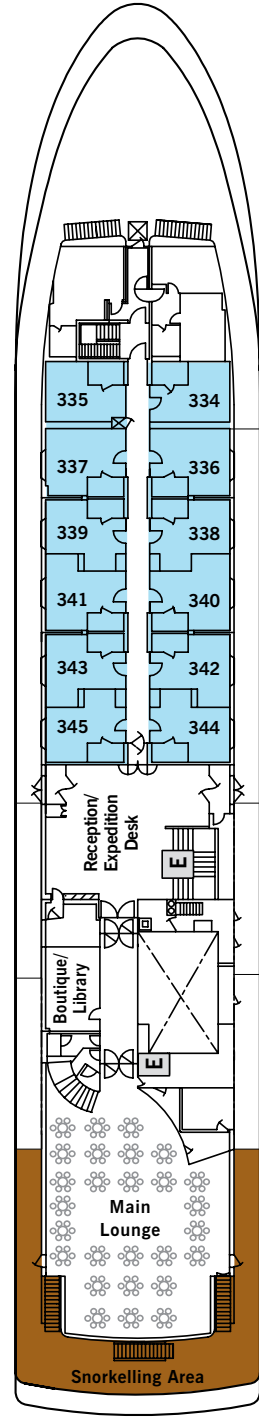
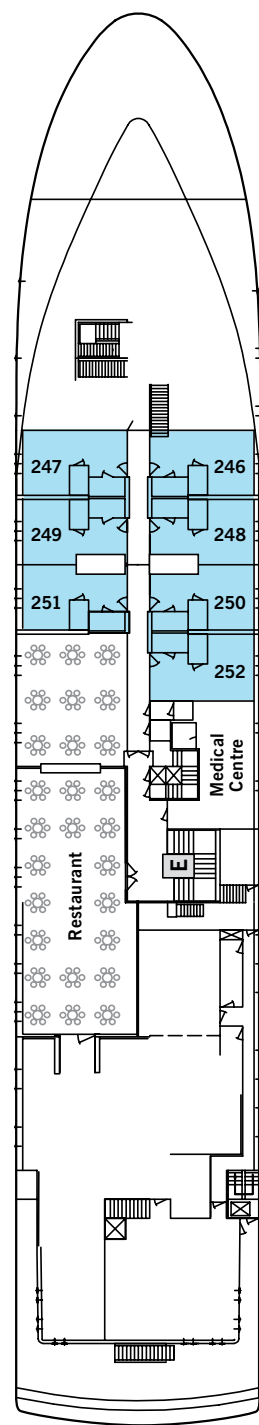

## SUITE CATEGORIES

- Silver Suite . . . . . ●
- Deluxe Veranda Suite . . . . . ●
- Veranda Suite . . . . . ●
- Terrace Suite . . . . . ●
- Explorer Suite . . . . . ●

## SPECIFICATIONS

- Crew . . . . . 75
- Officers . . . . . Ecuadorian
- Guests . . . . . 100
- Tonnage . . . . . 4,077
- Length . . . . . 289.24 Feet/88.16 Metres
- Width . . . . . 50.20 Feet/15.3 Metres
- Speed . . . . . 10/17 Knots
- Passenger Decks . . . . . 5
- Connecting Suites . . . 601/603, 602/604, 249/251, 248/250
- Built . . . . . in La Spezia (Italy)
- Registry . . . . . Ecuador

### DECK 2

The Restaurant  
Medical Centre

### DECK 3

Boutique/Library  
Main Lounge  
Reception/Expedition Desk  
Snorkelling Area

### DECK 4

Piano Bar

### DECK 5

The Grill

### DECK 6

Beauty Salon  
Fitness Centre  
Jacuzzi  
Massage Room

# Silver Galapagos – SUITE DIAGRAMS

All suites feature:

- Butler service
- Refrigerator and bar setup stocked with your preferences
- Eco-friendly bath amenities
- Pratesi fine bed linens and down duvets covers
- Premium mattresses
- Plush robes and slippers
- Binoculars
- Beach towels
- Rain coats
- WiFi Internet access (fee applies).

## SILVER SUITE — DECK 6

Owner's Suites can accommodate three guests.

361 SQ. FT. / 34 M<sup>2</sup> INCLUDING VERANDA  
(74 SQ. FT. / 7 M<sup>2</sup>)

- Large teak veranda with patio furniture and floor-to-ceiling glass doors
- Sitting area
- Twin beds or queen-sized bed
- Marbled bathroom with hair dryer
- Large wardrobe
- Vanity table
- Mini-bar with local snacks and drinks
- Wireless internet
- Flat screen television
- Direct-dial telephone(s)
- Special chocolate welcome and afternoon canapés upon request
- Illy Espresso machine
- Radio alarm with iPod docking station



## DELUXE VERANDA SUITE – DECK 4

Deluxe Veranda Suites can accommodate three guests..

303 SQ. FT. / 28 M<sup>2</sup> INCLUDING VERANDA  
(68 SQ. FT. / 6 M<sup>2</sup>)

- Large teak veranda with patio furniture and floor-to-ceiling glass doors
- Sitting area
- Twin beds or queen-sized bed
- Marbled bathroom with hair dryer
- Large wardrobe
- Vanity table
- Mini-bar with local snacks and drinks
- Wireless internet
- Flat screen television
- Direct-dial telephone(s)
- Special chocolate welcome and afternoon canapés upon request
- Illy Espresso machine
- Radio alarm with iPod docking station



## VERANDA SUITE — DECK 5

Veranda Suites can accommodate three guests.

268 SQ. FT. / 25 M<sup>2</sup> INCLUDING LARGE VERANDA (53 SQ. FT. / 5 M<sup>2</sup>)

- Large teak veranda with patio furniture and floor-to-ceiling glass doors
- Sitting area
- Twin beds or queen-sized bed
- Marbled bathroom with hair dryer
- Large wardrobe
- Vanity table
- Mini-bar with local snacks and drinks
- Wireless internet
- Flat screen television
- Direct-dial telephone(s)
- Special chocolate welcome and afternoon canapés upon request
- Radio alarm with iPod docking station



## TERRACE SUITE — DECK 5

Terrace Suites can accommodate three guests.

287 SQ. FT. / 26.38 M<sup>2</sup>

- Large picture window providing panoramic ocean views
- Large shared teak terrace with patio furniture
- Sitting area
- Twin beds or queen-sized bed
- Marbled bathroom with hair dryer
- Large wardrobe
- Vanity table
- Mini-bar with local snacks and drinks
- Wireless internet
- Flat screen television
- Direct-dial telephone(s)
- Special chocolate welcome and afternoon canapés upon request
- Radio alarm with iPod docking station



## EXPLORER SUITE — DECKS 2, 3, 4

Explorer Suites can accommodate three guests. *Suites 334 and 335 only accommodate two guests.*

DECKS 3 & 4: 250 – 235 SQ. FT. / 23 – 22 M<sup>2</sup> WITH VIEW WINDOW

DECK 2: 240 – 210 SQ. FT. / 22 – 20 M<sup>2</sup> WITH THREE PORTHOLE

- View window (Decks 3 and 4)
- Three portholes (Deck 2)
- Sitting area
- Twin beds or queen-sized bed
- Marbled bathroom with hair dryer
- Large wardrobe (Suites 248, 249, 250, 251 have walk-in closets)
- Vanity table
- Mini-bar with local snacks and drinks
- Wireless internet
- Flat screen television
- Direct-dial telephone(s)
- Special chocolate welcome and afternoon canapés upon request
- Radio alarm with iPod docking station



Deck 2 Diagram with Walkin Closets



Decks 3, 4

Suite diagrams and deck plans are for illustration purposes only.